

Posilok® Plus Mining Tooth System

NEW EXTENDED WEAR POINT SHAPE 112TKTVP

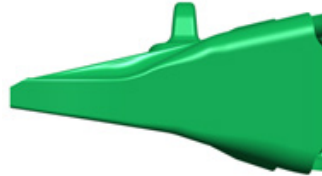

A



B



C

SITUATION

Mining customers in abrasive applications have typically used the Posilok 112KTVP point shape for shaving layered or stratified materials. This point shape has great penetration in high abrasion, low impact applications, but is not a hammerless system.

MODIFICATION

ESCO offers this style point in a Posilok Plus version, 112TKTVP. The new 112TKTVP point provides customers with the benefits of the Posilok point, but with the added benefit of a fully hammerless locking system for increased safety.

RESULT

The Posilok Plus point provides customers with the benefits of the Posilok point, with the added benefit of a completely hammerless system, making this a safer option.

112TKTVP

- A** Isometric view of point 112TKTVP
- B** Side view of point
- C** Top view of point

PART NUMBERS

PMID	Part No.	Weight (kg/lbs)
112TKTVP	4210646	41 / 90

SPECIFICATIONS

PART ID	A LENGTH mm / in	B WIDTH mm / in	C BIT THICKNESS mm / in	D WIDTH AT REAR mm / in	WEIGHT kg / lb	LOCKING PIN
112TKTVP	378 / 14.89	360 / 14.16	19 / 0.75	353 / 13.88	41 / 90	112TKPN-B

Contact Your ESCO Dealer